

Quick Start Guide

Parani-MSP100

For Wireless Multi-Serial Communications,
based on Bluetooth Technology



SENA
www.sena.com



Connection

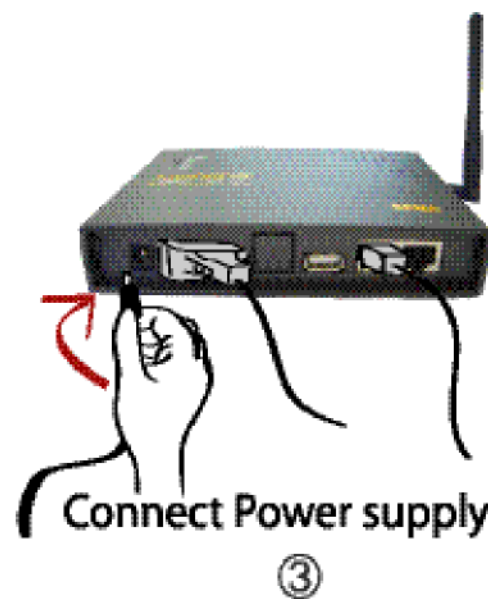
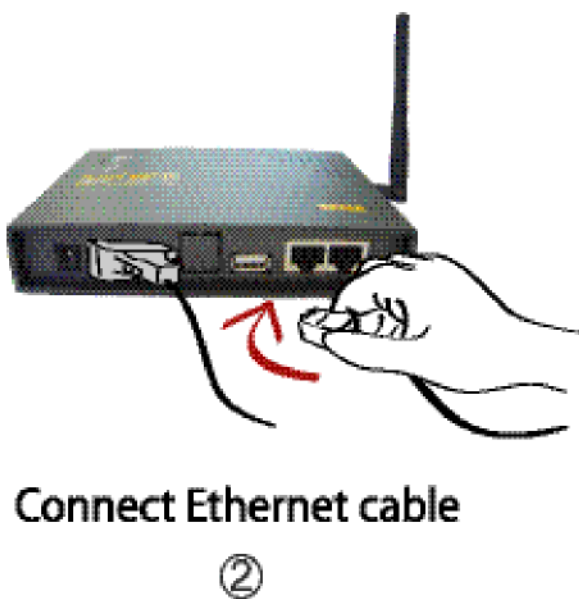

Installation

Connect the Parani-MSP100 to PC via RS-232 cable and open Hyper terminal program



Default IP mode of the Parani-MSP100 is "Static IP". To configure the Parani-MSP100 using Parani-MSP100 Manager, you need to change the IP mode to "DHCP IP" using a hyper terminal program.

Configuration

Configuration using the Parani-MSP100 Manager, Web or Hyper terminal

After running the configuration software, web or hyper terminal, Users will need to enter User ID and Password. Default User ID and Password is "admin/admin".

For more information, refer to the user manual.

You may download the Parani-MSP100 Manager and User Manual from CD or Sena website at <http://www.sena.com/support/downloads/>

Note : Operation Modes

In Bluetooth wireless communication, the Parani-MSP100 works only on server side. So, the Parani-SD or Parani-ESD Series will try to connect to the Parani-MSP100. But, "Server Mode" and "Client Mode" mean connections between the Parani-MSP100 and remote host PC via Ethernet network.

Mode	Description
Server Mode	The Parani-MSP100 will act as a TCP server on the network. Generally, this mode is widely used.
Client Mode	The Parani-MSP100 will act as a "TCP client" on the network. Remote host PC will act as a TCP server. Server daemon like the UniversalComm should be installed in remote host PC. The UniversalComm is available for download from sena web or CD.
Vertex Mode	Vertex Mode is similar to Server Mode. Only difference is that data from a Host are sent to all of connected Bluetooth devices, like Multi-drop. This mode can be a replacement of RS485/RS422 multi-drop.

Mode	Description
Repeater Mode	The Parani-MSP100 in Repeater Mode can be used to function as a Repeater to extend the range of Bluetooth network or avoid obstacles between the Parani-MSP100 and Bluetooth devices. Repeater Parani-MSP100s up to 7 can be connected to one Station Parani-MSP100, but Repeater-to-Repeater connection (Multi-level repeater) is not allowed.
Serial Hub Mode	The Parani-MSP100 relays data communication between Bluetooth devices. Using the Parani-MSP100, the Parani-SD Series can communicate each other, 1:N multi-serial with the Parani-SD Series. This mode doesn't need network connectivity. Only power-supply needed.
RS232 Mode	The Parani-MSP100 may act as 1:N multi-serial port by its RS232 port. The Parani-MSP100 handles data in Multi-drop way, so data written to RS232 interface of the Parani-MSP100 will be delivered to all of connected Bluetooth devices. The Parani-MSP100 is connected to host PC via serial data cable. DIP-Switch must be located right-side(RS232).

Visit us at www.sena.com

Copyright 1998-2006, Sena Technologies, Inc. All rights reserved.